

MARTINS
INDUSTRIES

TIRE SHELVING

MTSR-3 / MTSR-4 / MTSR-5

MARTINSINDUSTRIES.COM

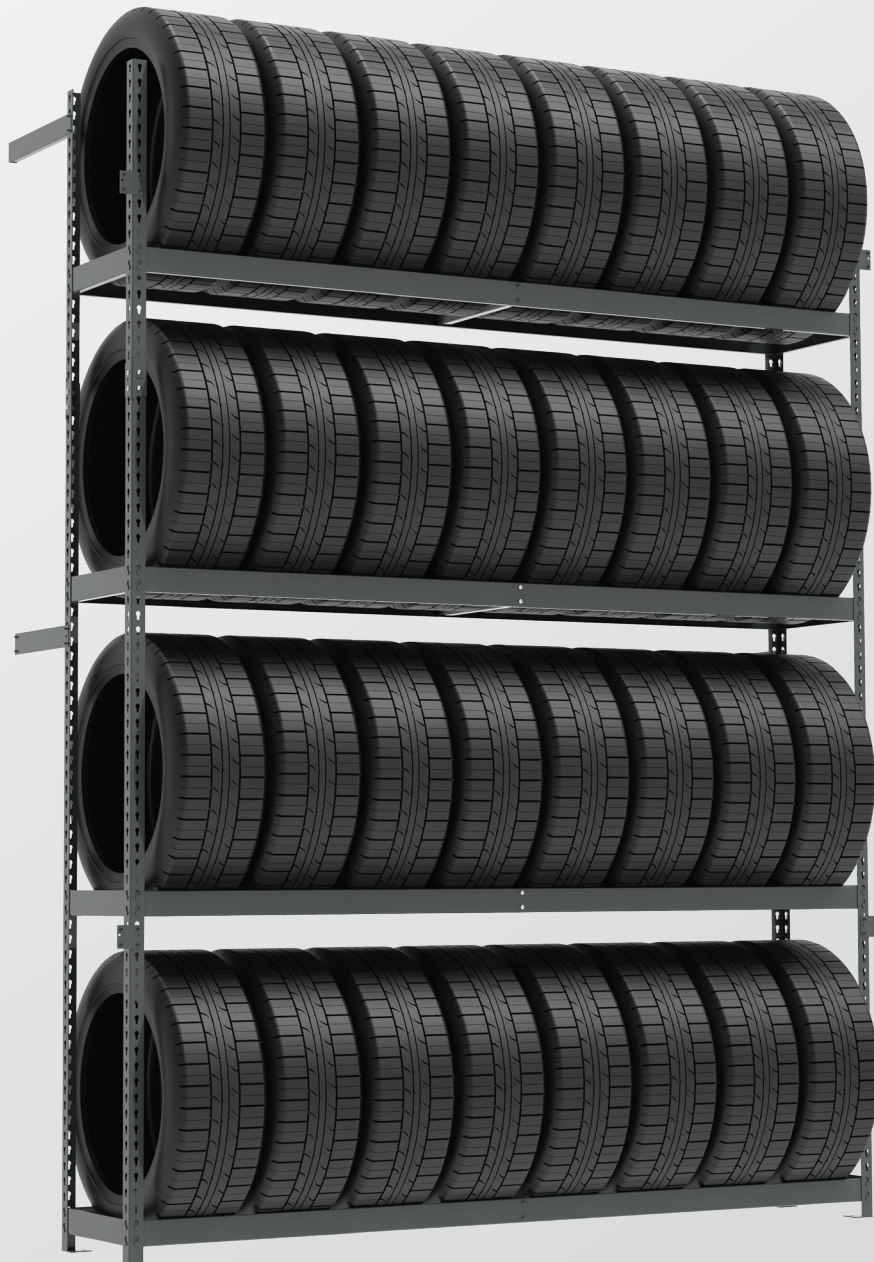

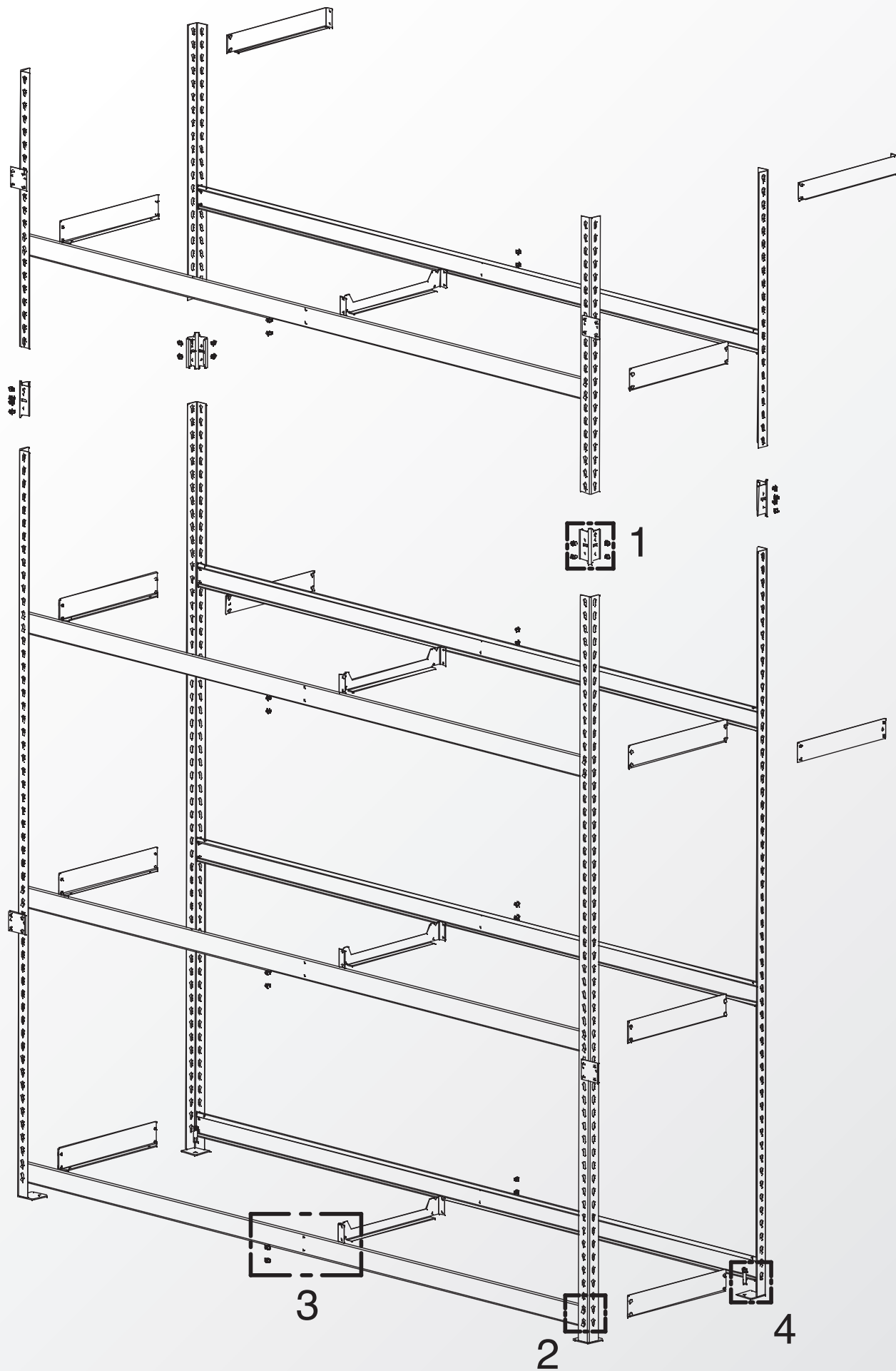

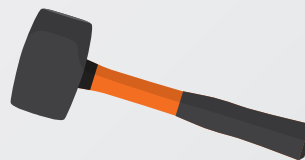
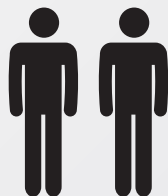

MTSR-4 & MTSR-5

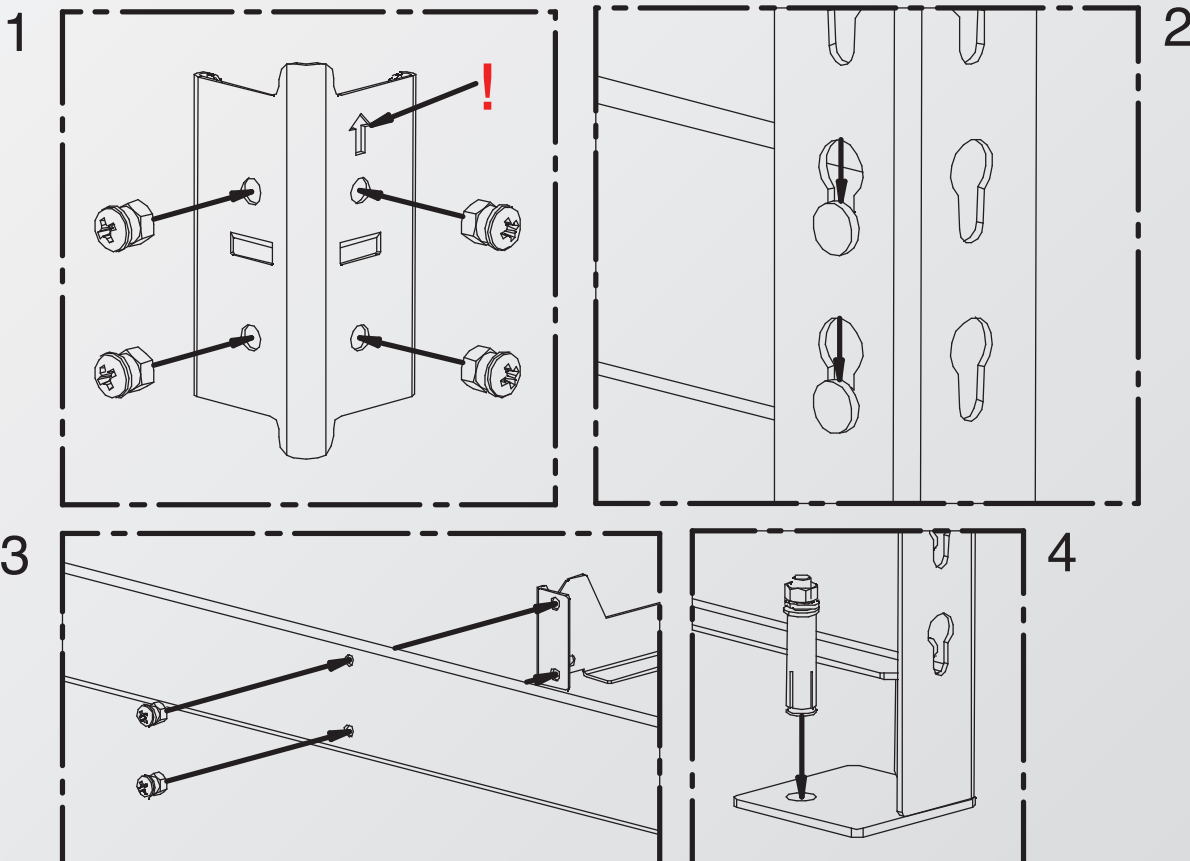

EN

Shelving must be fixed to the floor using provided anchors.
Shelving must be fixed to the wall or onto another shelving section using provided brackets.

FR

L'étagère doit être fixée au sol par les ancrages fournis.
L'étagère doit être fixée au mur ou fixer à une autre section d'étagère avec les attaches murales.

ESP

Las estanterías se deben fijar al piso usando los sujetadores suministrados.
Las estanterías deben fijarse a la pared o a otra sección de estantería utilizando los soportes suministrados.

DE

Das Regal muss mit Hilfe der mitgelieferten Dübel am Boden befestigt werden.
Das Regal muss an der Wand oder mit Hilfe der mitgelieferten Halterungen an einem anderen Regalteil befestigt werden.

IT

La scaffalatura deve essere fissata al pavimento per mezzo delle ancore fornite.
La scaffalatura deve essere fissata alla parete o ad un'altra sezione della scaffalatura per mezzo delle staffe fornite.

The logo for Martins Industries features a stylized, light gray swoosh above the word "MARTINS" in a bold, white, sans-serif font. Below "MARTINS", the word "INDUSTRIES" is written in a smaller, white, spaced-out, sans-serif font.

MARTINS
INDUSTRIES